

② BL 16x152-152

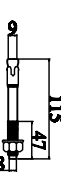

Anchored HBT M8 (Scale 1/2)

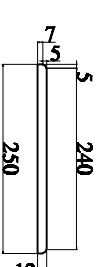
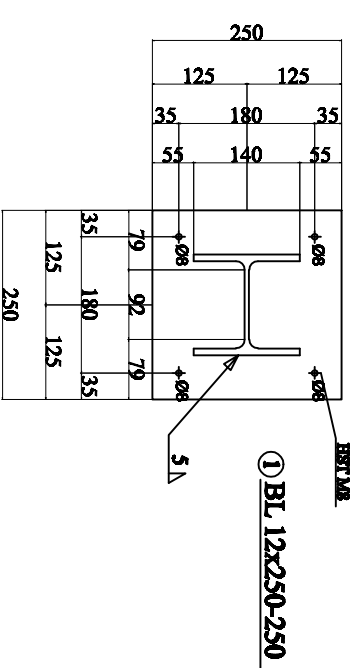
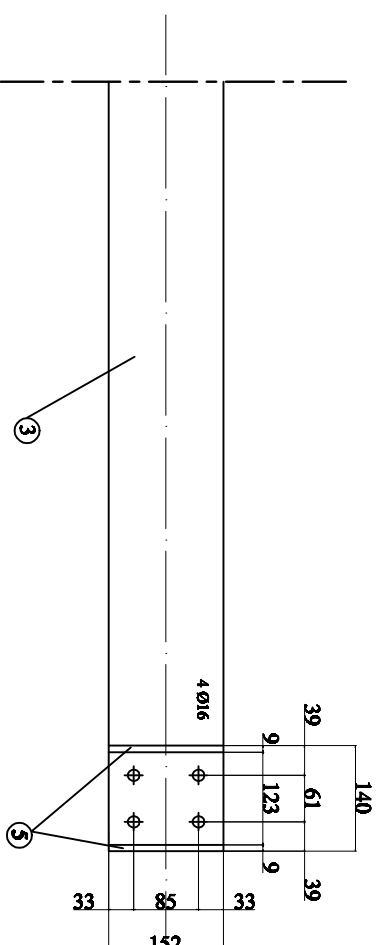
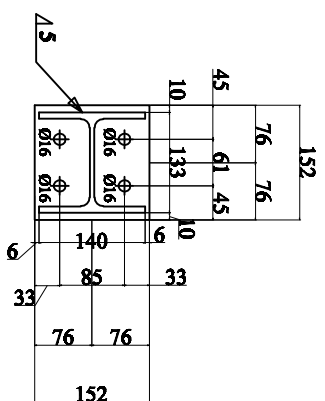
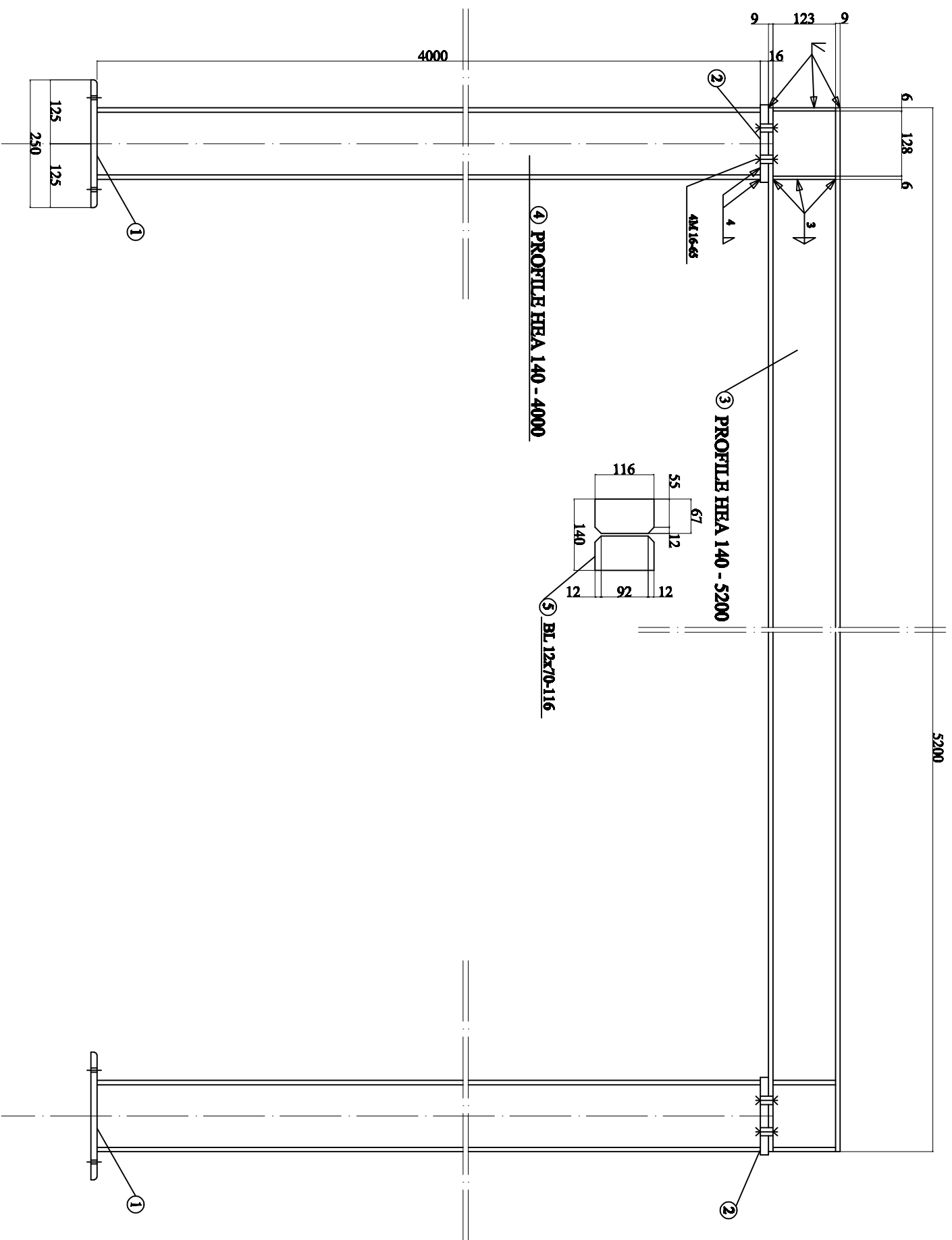

ELEMENT	NUMBER	MATERIAL	WEIGHT
BL 12x250-250	2	S235	5,89 kg
BL 16x152-152	2	S235	2,9 kg
PROFILE HEA 140 - 5200	1	S235	128,44 kg
PROFILE HEA 140 - 4000	2	S235	98,8 kg
BL 12x70-116	8	S235	0,76 kg

**POLITECHNIKA ŚLĄSKA**

Student : Juan Luis AYUSO MUELA

05 - 2010

Professor : Rafał KRZYWON

Scale : 1/10